

FIJI

2012/2013

Fly/Cruise Holidays

(includes all meals onboard cruise)



6 nights Fly/Cruise/Land from NZ\$1699* per person twin share

**Captain Cook
Cruises™**
THE SMALL SHIP CRUISE LINE

 **AIR PACIFIC**
FIJI'S INTERNATIONAL AIRLINE

worldtravellers

Cruising the tropical Fijian islands

Small ship cruising in Fiji

Imagine waking up every morning in a beautiful new paradise.

With 333 individual Islands covering over 194000 square kilometres of the South Pacific, Fiji is the essence of a tropical island paradise with white sandy beaches, swaying coconut trees, amazing snorkelling and diving and a unique culture and history. Add a year round warm tropical climate, breathtaking natural beauty, some of the most pristine waters in the world, a stunning Captain Cook cruise ship and you have all the ingredients of a dream holiday.

Cruise World in conjunction with Captain Cook Cruises and Air Pacific have put together a selection of special fly/cruise holiday packages from 6 to 8 nights exploring the exquisitely beautiful Yasawa Islands situated just 40km north west of Nadi. Cruising just a few short hours per day, leaving plenty of time to go ashore and explore play water sports, enjoy cultural activities... or simply do nothing at all.

You'll start your holiday from the moment you board your Air Pacific flight with their full service airline and friendly Fijian hospitality. For pre and post cruise accommodation we have a number of options from the 3 and a half star Mercure Nadi to the 5 star Sofitel Fiji Resort & Spa on Denarau Island.

Our packages are flexible so stay longer or just go for a long weekend whatever you decide you will enjoy a magical Fijian cruise set in some of the most pristine waters in the world!

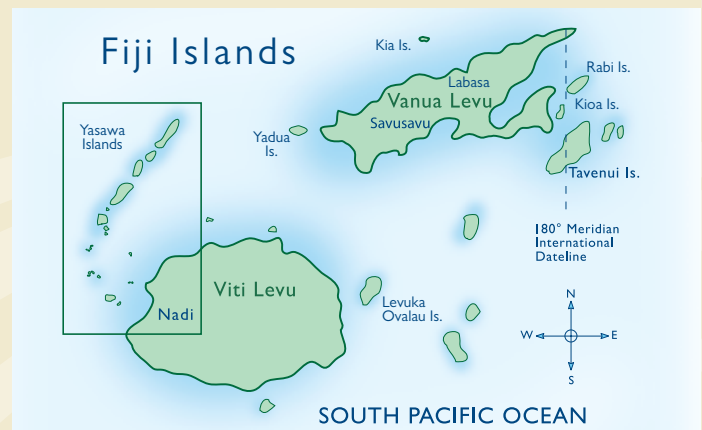
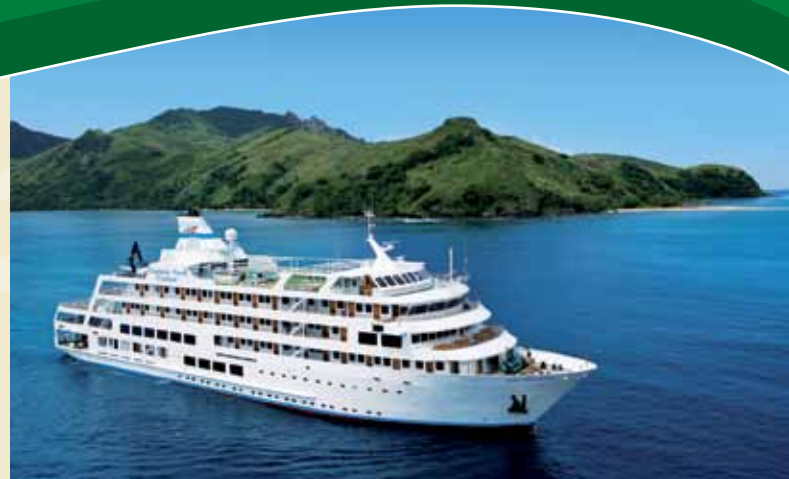

Air Pacific the national carrier of Fiji, is one the World's most experienced airlines recently celebrating its 60th Anniversary. Operating more than 500 flights per week to an extensive South Pacific network. Air Pacific flies directly from Auckland Christchurch to Nadi Fiji up to 13 flights a week. When you fly with Air Pacific all guests enjoy inclusive onboard meals, an extensive beverage selection, in-flight entertainment options and including one checked piece of up to 23kg of baggage allowance per person. You can simply sit back, relax and enjoy our friendly Fijian hospitality for your travel to your Fiji cruise holiday.

Tabua Class (Business Class)

Air Pacific's Business Class - Tabua Class is a fantastic way to start your cruise holiday to Fiji. There are a number of exclusive benefits to enjoy when flying with Air Pacific prior to your departure at the airport with a dedicated priority check in counter, priority baggage handling including up to 30kg checked in luggage and access to the Business Class lounge in Auckland and Nadi. While flying onboard in Tabua Class guests enjoy a superb selection of three course dining options including a range of fine wines, champagne, liqueurs and deserts. A variety of movie and TV channels are available on your personal TV screen. Choose from a range of music on our audio channels or relax in your Business Class seat with a selection of complimentary magazines and newspapers.

Captain Cook Cruise Packages

For the perfect compliment to your package holiday; Cruise World has selected **Captain Cook Cruises** who offer small-ship discovery cruises from the volcanic Yasawa Islands to the remote Northern Fiji Islands.

There's a Fiji Cruise adventure for the whole family – learn to dive Fiji, swim in the blue lagoon, discover ancient limestone caves, snorkel spectacular coral reefs, visit traditional villages and meet the locals.

The Ship

The **MV Reef Endeavour** is an intimate ship catering to no more than 140 passengers, ensuring every guest receives personal attention in an atmosphere of informality and relaxation.

Cruise Inclusions:

- Cruise accommodation
- All meals
- All on-board facilities
- Snorkelling equipment, glass bottomed boat excursions, village and island visits, cultural activities, meke and lovo feast, guided islands walks, Fijian VAT & HTT

Onboard Facilities:

- Swimming pool
- Sun deck
- Two bars
- Gift shop
- Chart house
- Guest laundry
- Spa
- Two lounges
- Sauna and mini gym
- Glass-bottomed boat
- Lift from D Deck to Sun Deck (limited access)
- Snorkelling and dive vessels
- Single-sitting dining saloon
- Library and videos
- 24 hour coffee and tea facilities
- Satellite communications, telephone and fax

Family

Reef Endeavour offers great value Family Cabins with two single beds and two upper pullman berths opening onto an inside passageway. Alternatively adjoining Staterooms can be booked at greatly reduced rates. Group child minding is provided on board for children 5-10 years inclusive at various times. Nanny hire is compulsory for children under 5 years and fees apply per 10 hour day. See conditions on back page.

Standard Honeymoon/Anniversary Bonus:

Complimentary bottle of sparkling wine in room on arrival.

Romance Package: Valid for travel to 31 March 2012

Including complimentary upgrade from Stateroom to Tabua Stateroom (subject to availability at time of sailing), a bottle of sparkling wine in room on arrival, Senikai 15 minute massage each and His & Her Senikai Essence of Viti gift pack.

Romance Package: Valid for travel 1 April 2012 – 31 March 2013

Including breakfast in bed one morning of the cruise, a bottle of sparkling wine in room on arrival, Senikai 15 minute massage each and His & Her Senikai Essence of Viti gift pack.

Accommodation before / after your cruise

So whether it's a romantic getaway or a family holiday the accommodation options before or after your cruise will suit all. Our packages are based on the **Mercure Nadi** which is set within five acres of tropical gardens and



Mercure Nadi



Novotel Nadi



Sofitel Fiji Resort & Spa

only minutes away from Nadi Airport. Mercure Nadi offers 85 spacious rooms, surrounding a tropical style swimming pool.

Alternatively we have upgrade options available at the newly transformed **Novotel Nadi** which is a four star resort style on 42 acres of tropical gardens complete with a 9 hole golf course, Senikai Day Spa and 2 restaurants & 2 bars.

Or simply treat yourself to the **Sofitel Fiji Resort & Spa** which is located on beautiful Denarau Island. This five star resort overlooks the beach front, adjacent to the world class Denarau Golf and Racquet club. Features at this luxury resort include a private beach, wedding chapel, swimming pools, three restaurants, four bars and international health spa.



6 Night Package With 3 night Southern Yasawa Islands cruise

Itinerary

Day One (Thursday) Arrive off your Air Pacific Flight from Auckland to Nadi

Transfer to your hotel on arrival. *Overnight at Mercure Nadi.*

Day Two (Friday) Own arrangements – why not explore Nadi or visit the beaches of Denarau. *Overnight at Mercure Nadi.*

Day Three (Saturday) This morning you will be transferred to the ship (Denarau Marina Nadi).

Cruise through to Day Six (Tuesday) On this short introduction to Fiji you'll discover the beauty of the Southern Yasawa Island Group and the overwhelming friendly warmth of its people.

The pristine islands of Waya, Naviti and Viwa boast some of the most beautiful beaches, sand cays and coral reefs in Fiji. On your journey through the Southern Yasawa Islands you'll experience a traditional village sevusevu ceremony and meet the children of an island school. Music and song is an integral part of Fijian life and the special choral church service on Sunday is an unforgettable experience. Swimming, snorkelling, beach combing and glass bottom boat tours complete your daily list of activities giving you the freedom to do as much or as little as you like.

Day Six (Tuesday) Disembark ship approx 9am and transfer back to your hotel. *Overnight at Mercure Nadi.*

Day Seven (Wednesday) Transfer to Nadi International Airport for your Air Pacific Flight from Nadi to Auckland.

Departure Dates

2011	NOV	DEC
12, 19,	3, 17,	
26	24, 31	

2012	JAN	FEB	MAR
14, 21,	4, 18,	3, 17,	
28	25	24, 31	
APR	MAY	JUN	
14, 21,	12, 19,	2, 16,	
28	26	23, 30	
JUL	AUG	SEP	
14, 21,	4, 18,	1, 15,	
28	25	22, 29	
OCT	NOV	DEC	
13, 20,	3, 17,	1, 15,	
27	24	22, 29	

2013	JAN	FEB	MAR
12, 19,	2, 16,	2, 16,	
26	23	23, 30	



Bonus offer – on all packages!

- An upgrade to a Deluxe room at the Mercure Nadi – Subject to availability
- A F\$50 bar credit for 2 adults on Captain Cook Cruise
- Return transfers – to/from Airport and to/from Captain Cook Ship

Hotel Upgrade Offers!

Available on 6 & 7 night packages

★★★★ Novotel Nadi Upgrade

\$30 pp twin share
\$45 pp single

*** Bonus *** Bonus *** Bonus *** Bonus *** Bonus ***

- Daily breakfast per person (Novotel)
- Late check out of 1pm (if required)

★★★★★ Luxury Upgrade Sofitel Fiji Resort & Spa

\$359 pp twin share
\$645 pp single

*** Bonus *** Bonus *** Bonus *** Bonus *** Bonus ***

- Superior resort room
- Daily breakfast Lagoon Restaurant
- 15% discount off food & beverage + 2 complimentary drink vouchers (wine/beer)

Notes: 15% discount valid for V, Lagoon and Salt restaurants.
Different room types available on request

Package Prices

Package prices are NZD, per person and are subject to currency fluctuations. Please contact your agent for details on departures after these dates.

Rates valid for Travel 01 Nov 2011 – 31 Mar 2012	Cabin	Stateroom	Tabua Stateroom
Twin/Double Share pp	\$1699	\$2119	\$2349
Single Occupancy	\$2085	\$2599	\$2885
Triple share pp	\$1525		
Child Rate 5–11 yrs (sharing with adults)	\$729	\$819	\$819
Rates valid for Travel 01 Apr – 30 Jun 2012	Cabin	Stateroom	Tabua Suite
Twin/Double Share pp	\$1789	\$2199	\$2739
Single Occupancy	\$2195	\$2709	\$3847
Triple share pp	\$1579		
Child Rate 5–11 yrs (sharing with adults)	\$747	\$839	\$1489

* For Children 12–15yrs add \$150 surcharge

* 0–4 yrs Children/Infants prices available on request (include compulsory nanny services)

* Interconnecting family cabins prices on request



7 Night Package With 4 night Northern Yasawa Islands cruise

Itinerary

Day One (Sunday) Arrive off your Air Pacific Flight from Auckland to Nadi. Transfer to your hotel on arrival. *Overnight at Mercure Nadi.*

Day Two (Monday) Own arrangements. *Overnight at Mercure Nadi.*

Day Three (Tuesday) This morning you will be transferred to the ship (Denarau Marina Nadi).

Cruise through to Day Seven (Saturday) This journey to sheltered bays and islands in the remote Northern Yasawa Group is everyone's tropical island dream – long white beaches, turquoise bays and colourful coral reefs.

The cruise begins with a visit to the private island of Tivua where you can swim, explore and relax before the Welcome Dinner. Over the next four days you will explore a thriving island village, visit a handicraft market and experience the culture first hand at a meke and lovo feast. As you cruise this spectacular passage from Yaqeta Island to the Yasawa's northern reaches, the vista is ever changing. From long tranquil aquamarine lagoons to imposing volcanic peaks, the Northern Yasawa Islands reveal Fiji's true natural beauty. The special Captain's Dinner completes your perfect Fiji island adventure.

Day Seven (Saturday) Disembark ship approx 9am and transfer back to your hotel. *Overnight at Mecure Nadi.*

Day Eight (Sunday) Transfer to Nadi International Airport for your Air Pacific Flight from Nadi to Auckland.



Hotel Upgrade Offers!

Please refer to page 4 for details

Bonus offer – on all packages!

- An upgrade to a Deluxe room at the Mercure Nadi – Subject to availability
- A F\$50 bar credit for 2 adults on Captain Cook Cruise
- Return transfers – to/from Airport and to/from Captain Cook Ship

Departure Dates

2011	NOV	DEC
8, 15	13, 20	
22, 29	27	

2012	JAN	FEB	MAR
10, 17	14, 21	13, 20	
24, 31	28	27	

APR	MAY	JUN
10, 17	8, 15	12, 19
24	22, 29	26

JUL	AUG	SEP
10, 17	14, 21	11, 18
24, 31	28	25

OCT	NOV	DEC
9, 16	13, 20	11, 18
23, 30	27	25

2013	JAN	FEB	MAR
8, 15	12, 19	12, 19	
22, 29	26	26	



Package Prices

Package prices are NZD, per person and are subject to currency fluctuations. Please contact your agent for details on departures after these dates.

Rates valid for Travel 01 Nov 2011 – 31 Mar 2012	Cabin	Stateroom	Tabua Stateroom
Twin/Double Share pp	\$1997	\$2530	\$2835
Single Occupancy	\$2445	\$3110	\$3485
Triple share pp	\$1759		
Child Rate 5–11 yrs (sharing with adults)	\$789	\$905	\$905
Rates valid for Travel 01 Apr – 30 Jun 2012	Cabin	Stateroom	Tabua Suite
Twin/Double Share pp	\$2145	\$2639	\$3359
Single Occupancy	\$2639	\$3225	\$4775
Triple share pp	\$1865		
Child Rate 5–11 yrs (sharing with adults)	\$809	\$935	\$1799

* For Children 12–15yrs add \$150 surcharge

* 0–4 yrs Children/Infants prices available on request (include compulsory nanny services)

* Interconnecting family cabins prices on request



8 Night Package With 7 night Yasawa Islands Cruise

Itinerary

Day One (Friday / Monday) Arrive off your Air Pacific Flight from Auckland to Nadi.

Transfer to your hotel on arrival. *Overnight at Mercure Nadi.*

Day Two (Saturday / Tuesday) This morning you will be transferred to the ship (Denarau Marina Nadi).

Cruise through to Day Nine A total Fiji cultural and island experience, this combination of both three and four night cruises brings together every fascinating experience of the Yasawa Islands from the north to the south, from culture to nature.

Between departures you can enjoy a choice of complimentary tours including the Garden of the Sleeping Giant or a tall ship adventure.

Day Nine (Saturday / Tuesday) Transfer to Nadi International Airport for your Air Pacific Flight from Nadi to Auckland.



Departure Dates

2011	NOV	DEC
8, 12,	3, 13,	
15, 19,	17, 20,	
22, 26,	24, 27,	
29	31	

2012	JAN	FEB	MAR
10, 14,	4, 14,	3, 13,	
17, 21,	18, 21,	17, 20,	
24, 28,	25, 28,	24, 27,	
31		31	

APR	MAY	JUN
10, 14,	8, 12,	2, 12,
17, 21,	15, 19,	16, 19,
24, 28,	22, 26,	23, 26,
	29	30

JUL	AUG	SEP
10, 14,	4, 14,	1, 11,
17, 21,	18, 21,	15, 18,
24, 28,	25, 28,	22, 25,
31		29

OCT	NOV	DEC
9, 13,	3, 13,	1, 11,
16, 20,	17, 20,	15, 18,
23, 27,	24, 27,	22, 25,
30		29

2013	JAN	FEB	MAR
8, 12,	2, 12,	2, 12,	
15, 19,	16, 19,	16, 19,	
22, 26,	23, 26,	23, 26,	
29	30		



Bonus offer - on all packages!

- An upgrade to a Deluxe room at the Mercure Nadi - Subject to availability
- A F\$50 bar credit for 2 adults on Captain Cook Cruise
- Return transfers - to/from Airport and to/from Captain Cook Ship

Package Prices

Package prices are NZD, per person and are subject to currency fluctuations. Please contact your agent for details on departures after these dates.

Rates valid for Travel 01 Nov 2011 - 31 Mar 2012	Cabin	Stateroom	Tabua Stateroom
Twin/Double Share pp	\$2599	\$3449	\$3690
Single Occupancy	\$3085	\$4149	\$4787
Triple share pp	\$2249		
Child Rate 5-11 yrs (sharing with adults)	\$919	\$1079	\$1079
Rates valid for Travel 01 Apr - 30 Jun 2012	Cabin	Stateroom	Tabua Suite
Twin/Double Share pp	\$2779	\$3555	\$4688
Single Occupancy	\$3335	\$4305	\$6695
Triple share pp	\$2375		
Child Rate 5-11 yrs (sharing with adults)	\$959	\$1170	\$2469

* For Children 12-15yrs add \$150 surcharge

* 0-4 yrs Children/Infants prices available on request (include compulsory nanny services)

* Interconnecting family cabins prices on request



Reef Endeavour Accommodation Deck Plans



SUN DECK

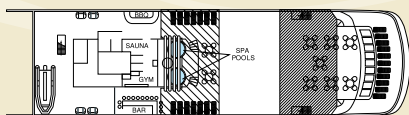

A DECK TOP DECK

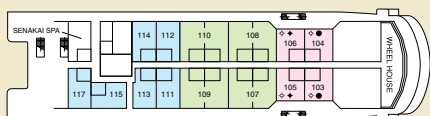

B DECK

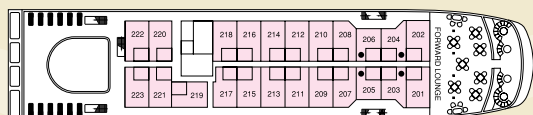

C DECK

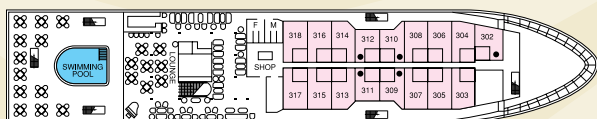

D DECK

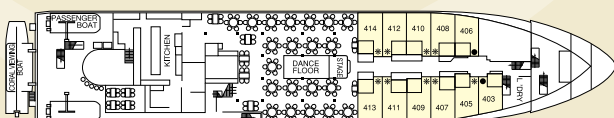

Tabua Suites (4)

A bedroom with separate lounge, chair, desk, LCD screen & DVD player, refrigerator, tea & coffee facilities and second bathroom. Upper Deck (A).
Configuration: twin/double beds

Tabua Staterooms (6)

Located on the Upper Deck (A), open onto the outside deck and have two windows.
Configuration: twin/double beds

Connecting Family Staterooms (2)

Located on the upper or main decks, open onto the outside deck and have picture windows.
Configuration: twin/double beds

Staterooms (4)

Located on the main decks (B & C) and open onto outside walkways, featuring two windows.
Configuration: twin/double beds

Cabins (11)

Located on the lower deck (D), open to an inside passageway and have portholes.
Configuration: twin/double/bunk triple/bunk quad

TABUA SUITE

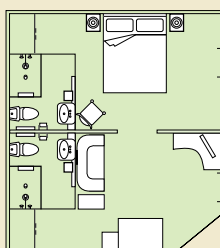

CONNECTING FAMILY STATEROOM

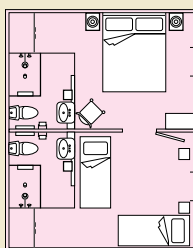

TABUA STATEROOM

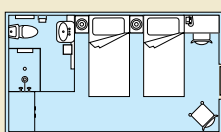

STATEROOM

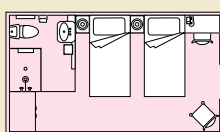

CABIN

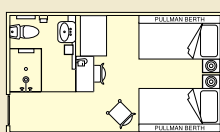

LEGEND

All rooms have twin beds convertible to double bed unless indicated as follows:

- Double bed
- * Family Cabins – twin single beds plus two upper Pullman berths
- ◆ Twin beds
- ◇ Connecting Family Staterooms

Tabua Suite



Stateroom



Cabin



8 Night - Discovery Heritage & Discovery Cultural Cruise Packages

The beauty of Fiji lies in its diversity – over 330 islands waiting to be explored. Discovery cruises are designed to offer you an authentic and personal experience of the Fijian Islands.

Discovery Heritage Cruise

Visit places without postcards as you embark on a special seven night adventure from the south-west coast of the main island to the remote northern Fiji Islands and across the 180th meridian.

Discovery Cultural Cruise

Circumnavigate Vanua Levu – Fiji's second largest island and explore the islands, rivers and rainforests of the remote north. On the way discover the three different cultures of the Ellice (Polynesian), Banabas (Micronesian) and the Fijian (Melanesian) people.

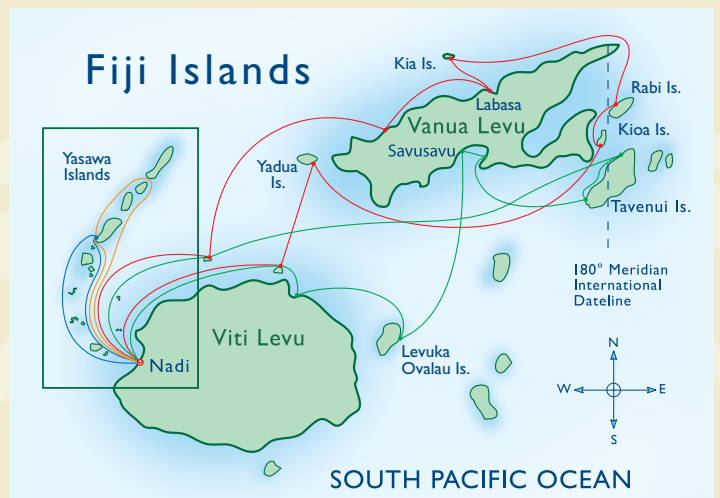

From \$2599 per person share twin
 (For departures before 31 March 2012)
 *Package price includes return flight to Nadi ex Auckland and 1 night at the Mercure Nadi

Departure Dates

2011	NOV	DEC
	1	6

2012	JAN	FEB	MAR
	3	7	6

APR	MAY	JUN
3	1	5

JUL	AUG	SEP
3	7	4

OCT	NOV	DEC
2	6	4

2013	JAN	FEB	MAR
	1	5	5

Discovery Heritage Cruise

Discovery Cultural Cruise

*All departures are on Tuesdays



Valid for sales until further notice

Fly/Cruise/Land Packages:

(Valid for departures until 30 June 2012)

Fly/Cruise/Land fares are per person, in **New Zealand dollars** and include an economy class flight EX: Auckland to/from Nadi flying Air Pacific with the selected Captain Cook cruise, accommodation at the Mercure Nadi and transfers to/from Nadi Airport and to/from Pt Denarau cruise terminal. Package includes port and handling charges, government taxes on the cruise, current airline taxes, security levies which are all subject to change.

Fly/Cruise/Land deposit of **\$300** is per person and is required within 7 days of confirmation. Options will auto cancel if payment is not received in our office by advised option date. Loss of deposit, cancellation and amendment fees apply to various package components. Passengers must be offered Travel Insurance.

Package fares are based on special fares and are not combinable with other discounts or offers. Offer is capacity controlled and may be withdrawn at any time.

Bookings are subject to any applied increases until payment is made. Increased charges on government taxes or airline taxes will be passed on to clients and may occur until departure. Fly/Cruise/Accommodation package is subject to currency fluctuations, please check at time of booking.

Departure dates – some dates are not available eg 17 Dec 2011 & 17 March 2012 CLOSED FOR MAINTENANCE.

Airfare (Air Pacific)

Flights are booked in **V** class. The air taxes included are estimated at NZ\$122, subject to increase at time of ticketing.

Economy

AKL – FJ – NAN – FJ – AKL

Travel must be completed by 30 June 2012

Minimum stay – 5 nights

Flights EX CHC: Available at a surcharge and travel only on certain days. Check with your travel agent.

Air tickets are subject to a 30 day prior to travel ticketing requirement, issued at the time of balance payment and are subject to general airfare rules, specified routing amendments, and cancellations conditions. Travel agents book flights and PNR to be forwarded for ticketing with balance. Flights are subject to availability at the time of booking.

Air Ticket – Changes/cancellations/refunds

Changes Before/After Departure – permitted after ticketing within fare rules/validity at a charge of NZD\$100 per passenger. An additional Cruise World amendment fee of \$50 may apply.

Note: All changes must be reissued within 24 hours of making the change. Full payment and ticketing must be completed no later than 30 June 2012.

Cancellation – No refunds after ticketing

**** Note children age up to 11 years, therefore children at 12–15 years incur a surcharge on package price ****

Cruise Package Conditions

Cancellation of bookings must be made in writing to Travel Marketing Cruise World. All tickets must be returned together with the notice of cancellation of booking which must be made in writing. Refunds are not processed until moneys are received from the cruise line or principal.

(a) Full payment of fare required no later than 30 days prior to sailing.

(b) Cancellation fees details below:

- 61+ days** Cruise World \$50 amendment/cancellation fee
- 31–60 days** Forfeit of deposit as administration fee plus electronic merchant or bank fees incurred on any transaction
- 15–29 days** 50% of the applicable cruise fare(s) plus Airfare
- 0–14 days** 100% of the applicable packaged fare(s)

*Note: All rates are inclusive of a maximum Value Added Tax (VAT) of 15% and Hotel Turnover Tax (HTT) of 5%, being the current legislated rate (June 2011) and may be subject to variation by the Government

of the day, Captain Cook Cruises reserves the right to increase fares without notice, however fully paid guest will be protected at their booked rate, except for, government taxes or other surcharges.

Cruise Inclusions

- Cruise Accommodation
- All meals
- All on-board facilities
- Snorkelling equipment, glass bottomed boat excursions, village and island visits, cultural activities, meke and lovo feast, guided island walks, Fijian VAT & HTT.

Price excludes: drinks, personal purchases, any optional tours such as scuba diving/Senikai Spa.

Child Policy

ALL children must be under the supervision of an adult at all times to the satisfaction of the ship's Master and must be able to swim unaided. Cruise Child rates apply to children 5–17 years sharing with adults. Group child minding is provided on board for children 5–10 years inclusive at the following times 9.00am–12noon, 2.00pm–5.00pm, 6.30pm–10.30pm.

Infants under 5 years are not recommended for this style of cruise and carried at Captain Cook Cruises absolute discretion (existing bedding). Infant rates (0–4 years) include Nanny Services up to 10 hours per day. Compulsory nanny charges, fees apply.

Accommodation

ARRIVAL TIME

Check-in time cannot be guaranteed prior to 1400 hours on the date of stay. Immediate check-in prior to 1400 requires full pre-registration. Check-out time 1100 hours at all Hotels unless prior arrangements are made.

DEPOSIT / CANCELLATIONS / NO-SHOW POLICY

In the event of a cancellation 48 hours or less prior to arrival or in the case of non-arrival, the Hotel will charge a fee of equal to the first night's accommodation.

Issued: 3-Nov-2011

For more information and bookings contact:



www.cruiseworld.co.nz

Cruise World Ltd
 P.O. Box 302 421, North Harbour
 Auckland, New Zealand
 Phone 09-917 4440
 0800 500 732 (outside Auckland)
 Fax 09-917 4443
 Email: info@cruiseworld.co.nz